

## MOBILE HOMES - PRICE-LIST FOR INDIVIDUAL GUESTS IN € - 2012

Mobile home rental & supplements in € daily								
Services	Seasons	01.05.-26.05. 08.09.-30.09.	26.05.-23.06.	01.09.-08.09.	23.06-30.06.	30.06.-07.07. 25.08.-01.09.	07.07.-14.07. 18.08.-25.08.	14.07.-18.08.
		Season 1	Season 2	Season 3	Season 4	Season 5	Season 6	Season 7
MOBILE HOME <i>Shelbox-Quarzo</i>		44	72	80	95	120	139	161
MOBILE HOME <i>SunRoller-Dalmacija</i>		48	76	85	100	125	144	166
MOBILE HOME <i>Shelbox-Tavolara</i>		48	76	85	100	125	144	166
Baby cot < 3 years		6	6	6	6	6	6	6
Pet		10	10	10	10	10	10	10
Minimum stay in days		3	3	7	3	7	7	7
Stay up to 3 days		±0%	±0%	+20%	±0%	+20%	+20%	+20%
Arrival-departure (check in-16:00, check out-09:00)		every day	every day	Sautrday/ Saturday	every day	Sautrday/ Saturday	Sautrday/ Saturday	Sautrday/ Saturday

Half-board (Breakfast+Dinner):	01.05.-23.06. 01.09.-30.09.	23.06.-01.09.
- adult	19	21
- child 0-2,99 years	Included	included
- child 3-11,99 years	Included	50%

- Special offer - ADAC CampCard 2012 (01.05.-23.06. and 08.09.-30.09.) - 10% discount.
- Tourist tax: is not included in the price. It is paid daily by all persons over 18 and amounts to € 1 a day. Persons 12 - 17,99 years of age pay 50 % tourist tax and children under 12 years of age are exempt from paying the tax.
- Rental of mobile homes includes: bed linen (exchange every 7 days), towels (exchange twice a week), electricity, water, gas, kitchen utensils, use of swimming-pool, animation and V.A.T.
- Down-payment: a reservation is confirmed after the down payment of € 250 has been made. The amount will be returned if the reservation is canceled 21 days before the guests' arrival date.
- In case of "no-show" or if the reservation is canceled up to 20 days prior arrival, the down-payment will not be returned
- Registration fee: € 1 per a person, to be paid once.
- Final cleaning: is not included in the rental price. Guests need to leave the mobile home clean, otherwise 35 € will be deducted from the deposit.
- Pets: allowed.
- All mobile homes are equipped with: air-conditioning, refrigerator, gas cooker with 4 rings, microwave oven, coffee machine, SAT TV and outdoor furniture.
- Deposit: € 100 is paid upon arrival.

Shelbox - Quarzo

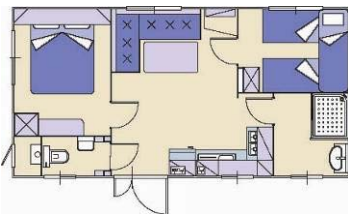

- Number of persons: 5 + 1
- Area size: 7,50 × 3,80 m = 28,50 m<sup>2</sup>
- Equipped with: bedroom (bed size 140×200 cm), bedroom (2 beds sized 70×190 cm + bunk bed), living / dining room (bed size 140×190 cm), kitchen corner, shower cabin, separate toilet.
- Electricity: 16 A
- Covered patio: 4 × 2,50 m = 10 m<sup>2</sup>

Sun Roller - Evasion Dalmacija

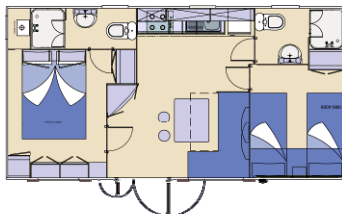

- Number of persons: 5 + 1
- Area size: 7,70 × 4 m = 30,80 m<sup>2</sup>
- Equipped with: bedroom (bed size 135×190 cm), bedroom (2 beds sized 80×190 cm + bunk bed), living / dining room (bed size 130×190 cm), kitchen corner, 2 x shower cabin / toilet.
- Electricity: 16 A
- Covered patio: 4 × 2,50 m = 10 m<sup>2</sup>

Shelbox - Tavolara

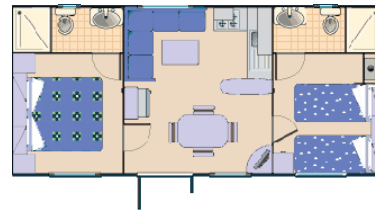

- Number of persons: 4 + 1
- Area size: 8 × 4 m = 32 m<sup>2</sup>
- Equipped with: bedroom (bed size 140×200 cm), bedroom (2 beds sized 80×200 cm), living / dining room (bed size 180×190 cm), kitchen corner, 2 x shower cabin / toilet.
- Electricity: 16 A
- Covered patio: 4 × 2,50 m = 10 m<sup>2</sup>